

Cylinder 6 stage front end with spherical eye

CD19TS6310715BA61295

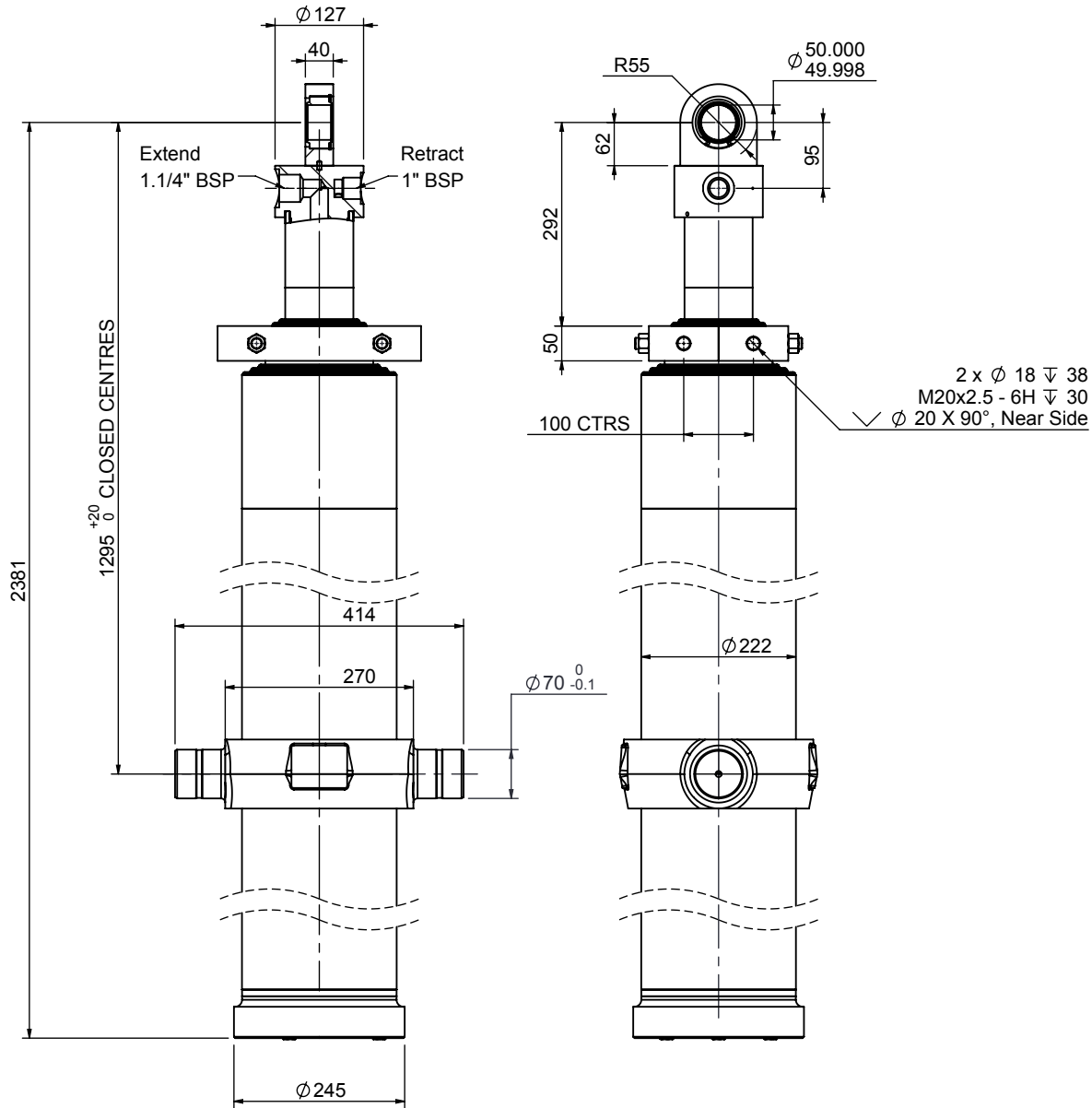

SPECIFICATION

Stage	Tube Diameter	Tube Bore	Length	Stroke	Swept Volume (Extend)	Swept Volume (Retract)
Base	222	206	2023	-	-	-
1	198	184	1984	1735	57.8	4.4
2	176	163	1984	1745	46.4	3.9
3	155	144	2034	1755	36.6	3.5
4	136	125	2034	1815	29.6	3.2
5	116	106	2034	1830	22.5	3.1
6	98	87	2184	1835	16.2	2.4
Total (+5/-10)				10715	mm	
Final stroke reduced by				0	mm	
Swept Vol (Extend)				209.1	Litres	
Swept Vol (Retract)				20.5	Litres	
Maximum Pressure				190	Bar	
Operating Pressure				190	Bar	
Cylinder Mass				406	Kg	
Stage	Thrust @ Max.Press		Thrust @ Op. Press			
	Extend	Retract	Extend	Retract		
1	64.6	4.9	64.6	4.9		
2	51.5	4.4	51.5	4.4		
3	40.4	3.9	40.4	3.9		
4	31.5	3.4	31.5	3.4		
5	23.8	3.3	23.8	3.3		
6	17.1	2.5	17.1	2.5		

NOTES

- This cylinder is intended for load ejection purposes only and should not be used for compacting.
- Cylinder is painted in primer to RAL5013.
- Refer to www.edbro.com for:-
 - Bracket details
 - Installation instructions that must be observed
 - Correct oil selection
 - An explanation of ejection capacity

INNER TUBES HARD CHROMED



JOST UK Ltd
 Edbro House, Nelson Street, Bolton, England, BL3 2JJ
 Tel +44 (0) 1204 528888 Fax +44 (0) 1204 531957
 Email: sales@jost-world.com Web: www.edbro.com

Technical Specifications are subject to change without notice
 Date Created/Updated: 20 May 2019
 Refer www.edbro.com to confirm latest specification
 All dimensions are in 'mm', unless otherwise stated