

Cylinder 7 stage front end with spherical eye

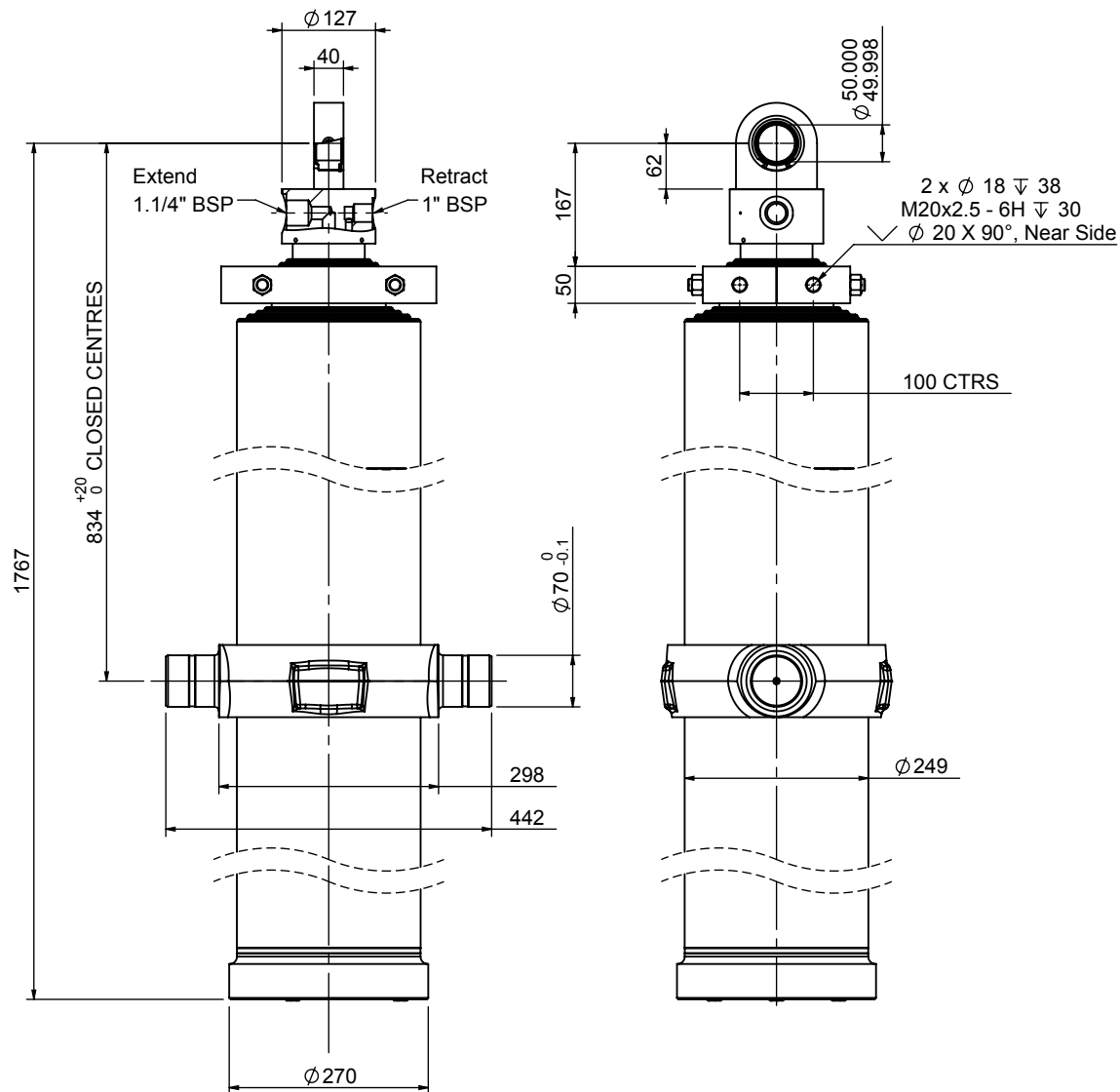

INNER TUBES HARD CHROMED

Edbro **JOST UK Ltd**
Edbro House, Nelson Street, Bolton, England, BL3 2JJ
Tel +44 (0) 1204 528888 Fax +44 (0) 1204 531957
Email: sales@jost-world.com Web: www.edbro.com

CD22TS7408986BA10826

SPECIFICATION

Stage	Tube Diameter	Tube Bore	Length	Stroke	Swept Volume (Extend)	Swept Volume (Retract)
Base	249	230	1529	-	-	-
1	222	206	1490	1234	51.3	3.5
2	198	184	1490	1242	41.4	3.2
3	176	163	1490	1251	33.3	2.8
4	155	144	1540	1261	26.3	2.5
5	136	125	1540	1321	21.5	2.3
6	116	106	1540	1336	16.4	2.3
7	98	87	1565	1341	11.8	1.7
Total (+5/-10)				8986	mm	
Swept Vol (Extend)				202	Litres	
Swept Vol (Retract)				18.3	Litres	
Maximum Pressure				190	Bar	
Operating Pressure				135	Bar	
Cylinder Mass				431	Kg	
Stage	Thrust @ Max.Press		Thrust @ Op.Press			
	Extend	Retract	Extend	Retract		
1	80.5	5.5	57.2	3.9		
2	64.6	4.9	45.9	3.5		
3	51.5	4.4	36.6	3.1		
4	40.4	3.9	28.7	2.7		
5	31.5	3.4	22.4	2.4		
6	23.8	3.3	16.9	2.3		
7	17.1	2.5	12.1	1.8		

NOTES

1. This cylinder is intended for load ejection purposes only and should not be used for compacting.
2. Cylinder is painted in primer to RAL5013.
3. Refer to www.edbro.com for:-
 1. Bracket details
 2. Installation instructions that must be observed
 3. Correct oil selection
 4. An explanation of ejection capacity

Technical Specifications are subject to change without notice
Date Created/Updated: 12 March 2021
Refer www.edbro.com to confirm latest specification
All dimensions are in 'mm', unless otherwise stated