

CYLINDER ASSY PART No : CS11EE402970001

TUBE	BORE	O/DIA	LENGTH	STROKE	THRUST @ 135 bar
OUTER COVER					
BASE RAM	125.00	136.00	875		
1ST EXT	106.00	117.00	890	735	14.70 t
2ND EXT	87.50	98.00	890	745	10.40 t
3RD EXT	71.00	79.50	890	745	6.85 t
4TH EXT	54.50	63.00	890	745	4.30 t
5TH EXT					t
6TH EXT					t
7TH EXT					t
8TH EXT					t

TOTAL STROKE	2970
WORKING VOLUME	19.25 litre
TOTAL VOLUME	23 litre
OIL TANK CAPACITY	litre
OPERATING PRESSURE	135 bar
FULL STROKE PRESSURE	150 bar
CYLINDER WEIGHT DRY	69 kg

GENERAL DIMENSIONS

A	1035	M	0.75" B.S.P
B	136	N	29
C	160		
D	150		
E	30		
F	55		
G	40.25/40.30		
H	40		
J	51.30/51.35		
K	100		
L	80		

DIMENSIONS IN MILLIMETRES UNLESS STATED OTHERWISE

NOTE: SMALL INNER O/D HARDCHROMED

AMENDMENTS	REV	MOD No
	E.R	8468

NOTE  
ALL ALTERATIONS TO THIS SHEET SHOULD BE CARRIED OUT ON THE CAD SYSTEM

This drawing is the property and copyright of EDBRO LTD and must not be re-issued, copied or reproduced without their consent.

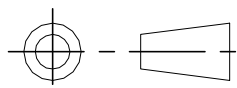

THIRD ANGLE PROJECTION



PROJECT CYLINDERS

TITLE	CYLINDER OUTLINE
DRAWN	R. WARBURTON
DATE	6 OCT 95
DRG.No	4A74175_2970

EDBRO LTD  
BOLTON  
LANCASHIRE  
ENGLAND