

Cylinder 5 stage front end with spherical eye

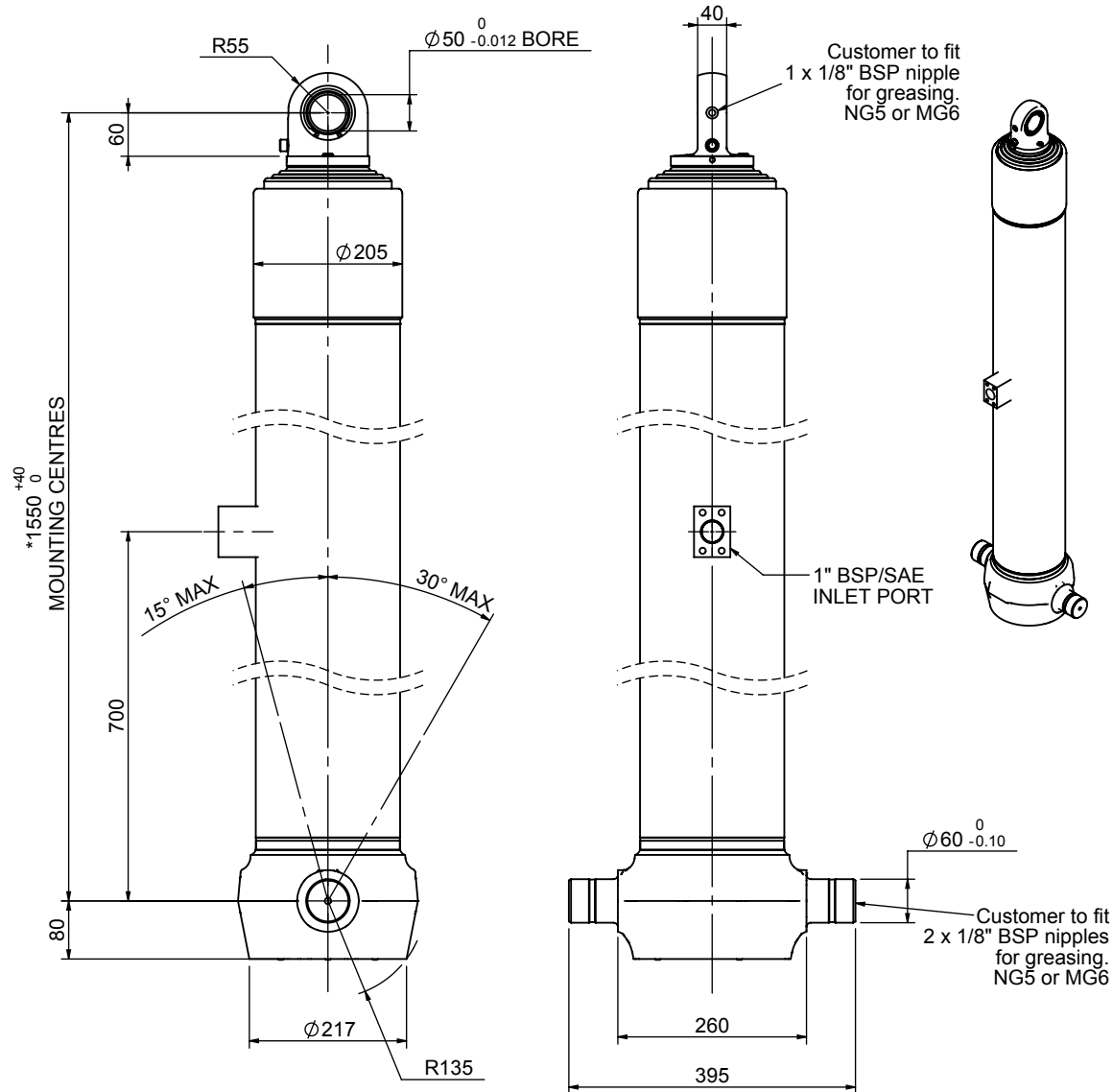

CS170S56483S70A01

SPECIFICATION		TIPPING CAPACITY : 25-35 TONNES***		
Stage	Diameter	Length	Stroke	Swept Volume
-	-	-	-	-
0	199	1525	-	-
1	176	1490	1267	31
2	155	1490	1287	24
3	136	1490	1297	19
4	117	1490	1312	14
5	98	1490	1317	10
Total (+5/-10)			6480	98
Final stroke reduced by	0	Priming Volume	20	
Cylinder Mass (Kg)	229	Total Volume (Litres)	118	
Maximum Pressure (Bar)	190	Max. first stage thrust	265 kN	

***TIPPING CAPACITY AT WORKING PRESSURE

BL	BODY LENGTH (BL)				OH	
	8000	8500	9000			
28	50°	26	46°	25	44°	150
31	52°	29	48°	27	45°	450
35	54°	32	50°	29	47°	750

$d = 0; r = 900$; Working Pressure 120 bar
For guidance only;
 Higher working pressures and tipping capacities may be possible.
 To check your application email - applications@edbro.co.uk

- NOTES**
- This cylinder is for lifting purposes only and side load conditions should be avoided
 - Cylinder is painted in primer paint to RAL5013
 - Refer to www.edbro.com for:-
 - Bracket details
 - Installation instructions that must be observed
 - Correct oil selection
 - An explanation of tipping capacity

*Includes 9mm Pull Out.
 Last Stage Chrome Plated



Edbro plc
 Nelson Street, Bolton, England, BL3 2JJ
 Tel +44 (0) 1204 528888 Fax +44 (0) 1204 531957
 Email: postmaster@edbro.com Web: www.edbro.com

Technical Specifications are subject to change without notice
 Date Created/Updated: 03 September 2012
 Refer www.edbro.com to confirm latest specification
 All dimensions are in 'mm', unless otherwise stated

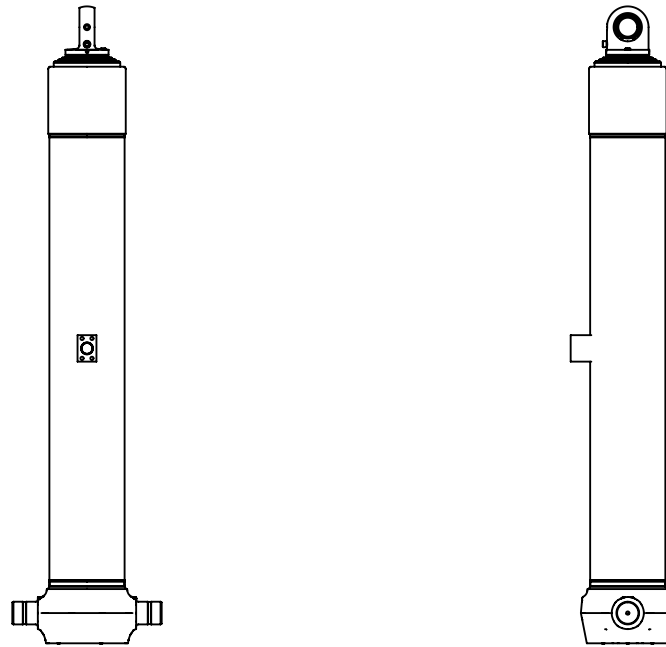

CS170S56483S70A01