

Cylinder 5 stage front end with spherical bearing

CS220S55530B39CAE

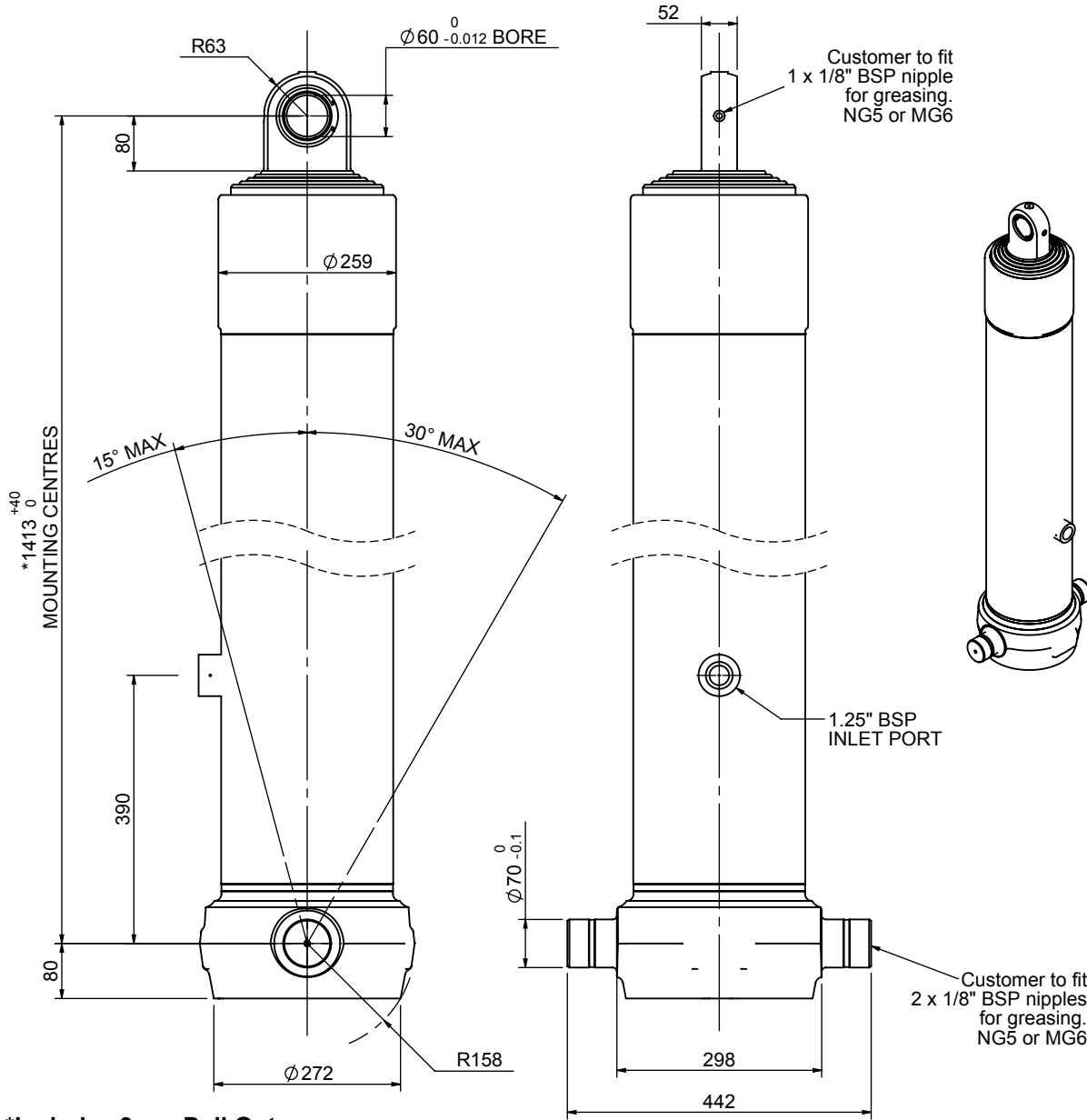

SPECIFICATION		TIPPING CAPACITY : 67-94 TONNES***		
Stage	Diameter	Length	Stroke	Swept Volume
-	-	-	-	-
0	250	1378	-	-
1	222	1340	1101	43
2	198	1340	1118	34
3	176	1340	1127	27
4	155	1340	1137	21
5	136	1340	1047	15
Total (+5/-10)			5530	140
Final stroke reduced by	100	Priming Volume		14.5
Cylinder Mass (Kg)	346	Total Volume (Litres)		154.5
Maximum Pressure (Bar)	190	Max. first stage thrust		400 KN

***TIPPING CAPACITY AT WORKING PRESSURE					
d	BODY LENGTH (BL)			OH	
	7500	7700	7900	200	500
72	45°	69	44°	67	43°
81	47°	77	46°	75	45°
94	50°	89	48°	84	47°

$d = 0$; $r = 1200$; Working Pressure 150 bar
 For guidance only;
 Higher working pressures and tipping capacities may be possible.
 To check your application email - applications@edbro.co.uk

- NOTES**
- This cylinder is for lifting purposes only and side load conditions should be avoided
 - Cylinder is painted in primer paint to RAL5013
 - Refer to www.edbro.com for:-
 - Bracket details
 - Installation instructions that must be observed
 - Correct oil selection
 - An explanation of tipping capacity

*Includes 9mm Pull Out. Last Stage Chrome Plated



Edbro plc
 Nelson Street, Bolton, England, BL3 2JJ
 Tel +44 (0) 1204 528888 Fax +44 (0) 1204 531957
 Email: postmaster@edbro.com Web: www.edbro.com

Technical Specifications are subject to change without notice
 Date Created/Updated: 11 March 2013
 Refer www.edbro.com to confirm latest specification
 All dimensions are in 'mm', unless otherwise stated

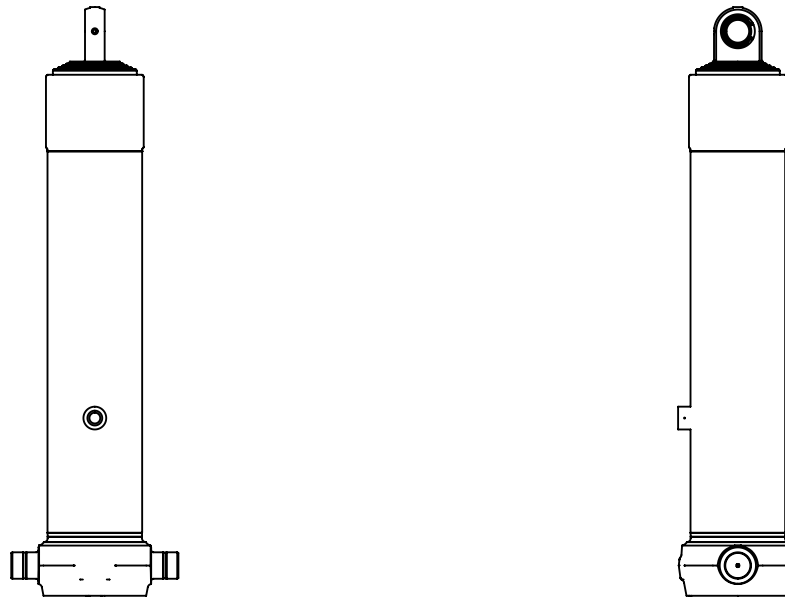

CS220S55530B39CAE