

Bent Axis Piston Pump: Tipper Applications - EBA13022

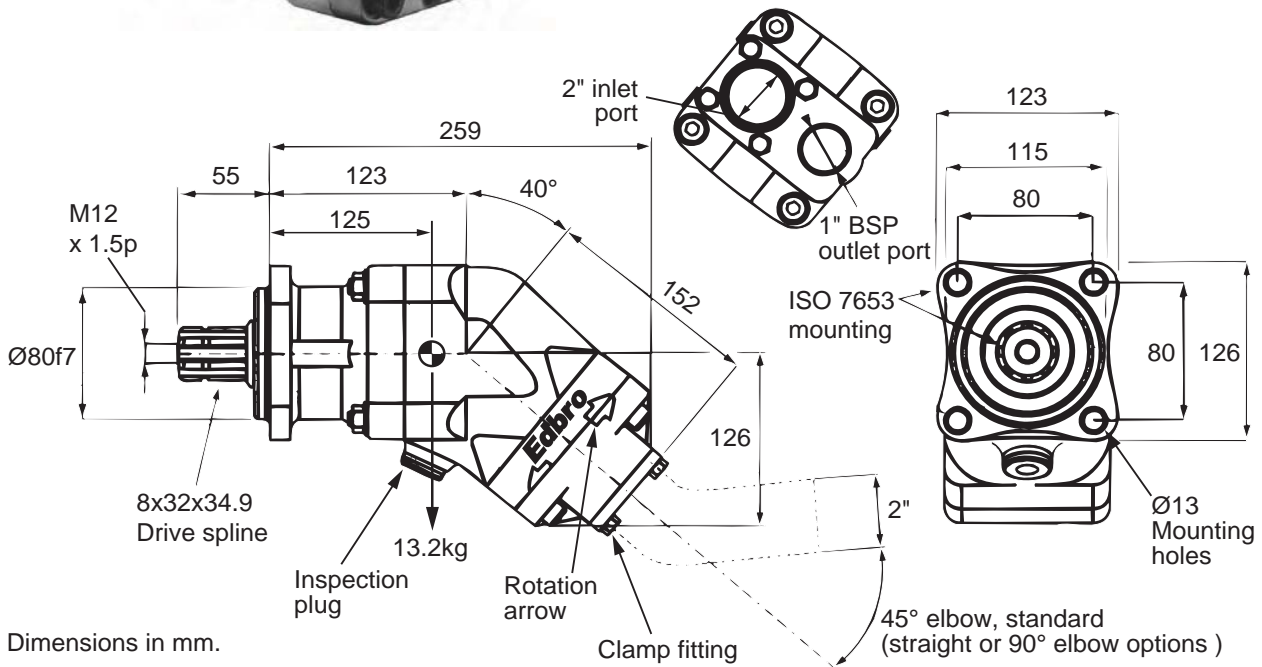

- 130 cm³/rev output flow
- Medium pressure (220 bar mwp)
- Compact size for easy installation
- Ideal for close coupled PTO mounting
- Lightweight aluminium casings
- Reversible rotation whilst installed
- 4 - Hole ISO7653 Mounting flange



PIPE ADAPTOR KIT OPTIONS

Low pressure inlet adaptors	High pressure outlet adaptor options	
	1 inch BSP straight (NR611/24, DPP45H)	1 inch BSP 90° Elbow (NR611/24, NR634, DPP45H)
2 inch push-on 45° elbow (NR1608)	AK59 (standard)	AK72
2 inch push-on 90° elbow (NR1605)	AK60	AK73
2 inch push-on straight (NR1615)	AK58	AK71
2 1/2 inch push-on	Details available on request	

All dimensions are given in mm unless otherwise stated. Technical Specifications are subject to change without notice.

Bent Axis Piston Pump: Tipper Applications - EBA13022

PERFORMANCE

Displacement	cm ³ /rev	130
Max. Working Pressure	bar	220
Max. Working Speed	rpm	2000
Max. Speed Off-Load	rpm	2300
Power	Kw	95
Weight	kg	13.2
Moment at PTO face	Nm	16.2

PIPES

Size: Suction 2 inch minimum
Pressure 1 inch minimum
For improved high speed efficiency and to avoid cavitation, a 2 1/2 inch suction pipe must be used. The suction pipe must be able to withstand -12psi (-0.8bar) pressure. Pipe runs should be direct and short, with no kinks.

OIL & FILTRATION

This pump is designed for low pressure, intermittent use, tipper systems without filtration. The oil should be a good quality hydraulic oil to ISO 6743/4 HM32 for -15° to +27°C working temperature. For extended life or for higher duty applications, 25µm absolute return line filtration is recommended. Oil cleanliness to be maintained to ISO 4406 class 19/16. Oil should be replaced annually.

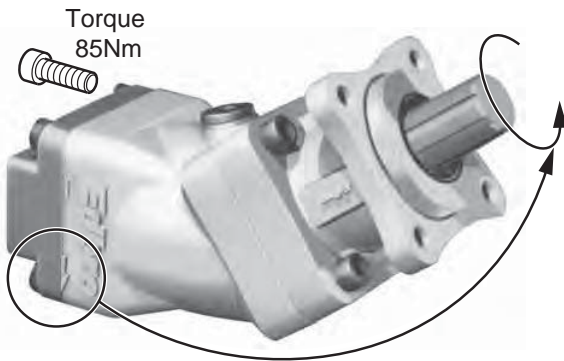
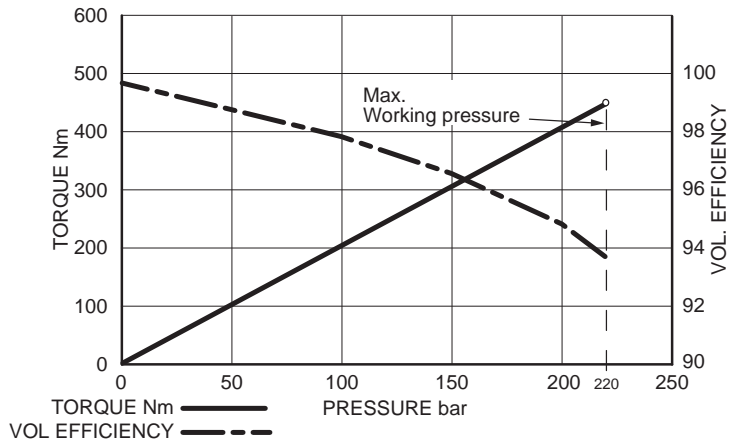
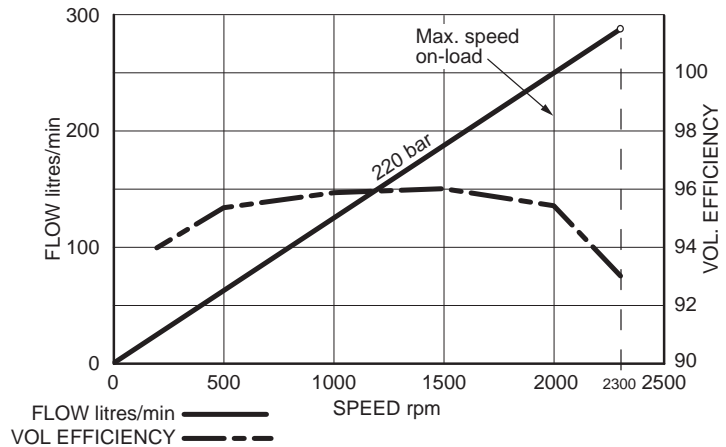

ROTATION DIRECTION

The rotation direction is shown by the complete arrows on the pump casing, and is specified as clockwise (right hand rotation) or anti-clockwise (left hand rotation), when viewed looking toward the pump along the splined shaft.

To change the rotation direction, remove the 4 setscrews and lift the end cover by a few mm.

Rotate through 180° push back into place and replace the setscrews.

Unless specially requested, ANTI-CLOCKWISE configuration will be supplied.